

TYCP 系列超高效率三相变频永磁同步电动机

TYCP Series Premium-Efficiency Three Phase Variable Frequency Permanent Magnet Synchronous Motors

机座号: 80~355

功率: 0.55~375kW

工作制: S1

冷却方式: IC411

能效等级: 中国 GB30253-2013 1 级

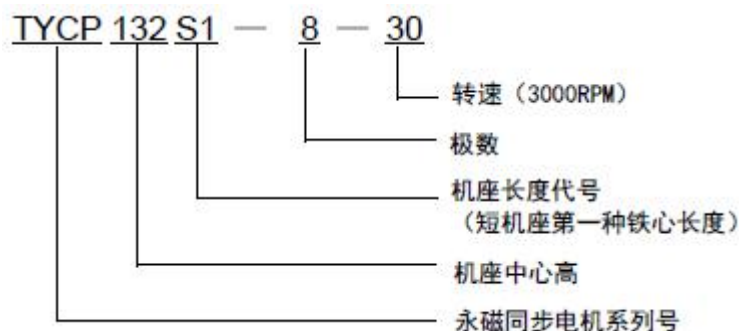

用于: 需要连续节能运行的一般使用场所, 如机床、风机、水泵、运输机械、轻工机械等。

Applications: Energy saving applications where continuous of frequent duty is required, like machines, pumps, fans, conveyors, or light industry machinery etc.

特点: T 代表同步, YC 代表永磁, P 代表风机水泵或一般型负载。高效节能(效率符合 GB30253-2013 中规定的 1 级能效), F 级绝缘, 防护等级

为 IP55, 噪声低、振动小, 配合 WN90T 系列变频器, 可满足多种工况下稳定运行。

Features: T means for synchronous, YC for permanent magnet, and P for the general driven load. The series motors have many virtues: beautiful profile, high efficiency and energy saving, F insulation, IP55 protection, low noise, little vibration, reliable running. Operating with WN90T inverter, the motor can be applied in various condition.

性能数据 Performance Data

380V

型 号 Type	功率 kW	额定 电流 A	额定 转速 r/min	效率 Eff. %	功率 因数 P.F	额定 转矩 N.m	噪声 dB (A)	适配变频器 Inverter
同步转速 3000 r/min				额定频率 200Hz				
TYCP80M1-8-30	0.75	1.35	3000	88.6	0.95	2.39	62	WN90T-0.7G-4
TYCP80M2-8-30	1.1	1.96	3000	89.8	0.95	3.50	62	WN90T-0.7G-4
TYCP90S-8-30	1.5	2.64	3000	90.9	0.95	4.77	67	WN90T-1.5G-4
TYCP90L-8-30	2.2	3.83	3000	91.8	0.95	7.00	67	WN90T-2.2G-4
TYCP100L-8-30	3	5.18	3000	92.6	0.95	9.55	74	WN90T-3.7G-4
TYCP112M-8-30	4	6.86	3000	93.3	0.95	12.73	77	WN90T-3.7G-4
TYCP132S1-8-30	5.5	9.36	3000	94	0.95	17.51	79	WN90T-5.5G-4
TYCP132S2-8-30	7.5	12.69	3000	94.5	0.95	23.87	79	WN90T-7.5G-4
TYCP160M1-8-30	11	18.52	3000	95	0.95	35.01	81	WN90T-11G-4
TYCP160M2-8-30	15	25.17	3000	95.3	0.95	47.75	81	WN90T-15G-4
TYCP160L-8-30	18.5	30.95	3000	95.6	0.95	58.89	81	WN90T-18.5G-4

性能数据 Performance Data

380V

型 号 Type	功率 kW	额定 电流 A	额定 转速 r/min	效率 Eff. %	功率 因数 P.F	额定 转矩 N.m	噪声 dB (A)	适配变频器 Inverter
同步转速 3000 r/min 额定频率 200Hz								
TYCP180M-8-30	22	36.69	3000	95.9	0.95	70.03	83	WN90T-22G-4
TYCP200L1-8-30	30	49.93	3000	96.1	0.95	95.49	84	WN90T-30G-4
TYCP200L2-8-30	37	61.45	3000	96.3	0.95	117.8	84	WN90T-37G-4
TYCP225M-8-30	45	74.66	3000	96.4	0.95	143.2	86	WN90T-45G-4
TYCP250M-8-30	55	91.15	3000	96.5	0.95	175.1	89	WN90T-55G-4
TYCP280S-8-30	75	124.2	3000	96.6	0.95	238.7	91	WN90T-75G-4
TYCP280M-8-30	90	148.9	3000	96.7	0.95	286.5	91	WN90T-90G-4
TYCP315S-8-30	110	181.9	3000	96.7	0.95	350.1	92	WN90T-110G-4
TYCP315M-8-30	132	218.3	3000	96.7	0.95	420.2	92	WN90T-132G-4
TYCP315L1-8-30	160	264.6	3000	96.7	0.95	509.3	92	WN90T-160G-4
TYCP315L-8-30	185	306.0	3000	96.7	0.95	588.9	92	WN90T-185G-4
TYCP315L2-8-30	200	330.8	3000	96.7	0.95	636.6	92	WN90T-200G-4
TYCP315L3-8-30	220	363.94	3000	96.7	0.95	700.3	92	WN90T-220G-4
TYCP315L4-8-30	250	413.5	3000	96.7	0.95	795.8	92	WN90T-250G-4
TYCP355M1-8-3	220	363.9	3000	96.7	0.95	700.3	100	WN90T-220G-4
TYCP355M-8-30	250	413.58	3000	96.7	0.95	795.8	100	WN90T-250G-4
TYCP355L1-8-30	280	463.1	3000	96.7	0.95	891.3	100	WN90T-280G-4
TYCP355L-8-30	315	521.0	3000	96.7	0.95	1003	100	WN90T-315G-4
TYCP355L2-8-30	355	587.1	3000	96.7	0.95	1130	104	WN90T-350G-4
TYCP355L3-8-30	375	620.2	3000	96.7	0.95	1194	104	WN90T-400G-4
同步转速 1500 r/min 额定频率 100Hz								
TYCP80M1-8-15	0.55	1.03	1500	85.6	0.95	3.50	56	WN90T-0.4G-4
TYCP80M2-8-15	0.75	1.40	1500	85.6	0.95	4.77	56	WN90T-0.7G-4
TYCP90S-8-15	1.1	2.01	1500	87.4	0.95	7.00	59	WN90T-0.7G-4
TYCP90L-8-15	1.5	2.72	1500	88.1	0.95	9.55	59	WN90T-1.5G-4
TYCP100L1-8-15	2.2	3.92	1500	89.7	0.95	14.01	64	WN90T-2.2G-4
TYCP100L2-8-15	3	5.31	1500	90.3	0.95	19.10	64	WN90T-3.7G-4
TYCP112M-8-15	4	7.04	1500	90.9	0.95	25.46	65	WN90T-3.7G-4
TYCP132S-8-15	5.5	9.55	1500	92.1	0.95	35.01	71	WN90T-5.5G-4
TYCP132M-8-15	7.5	12.95	1500	92.6	0.95	47.75	71	WN90T-7.5G-4
TYCP160M-8-15	11	18.80	1500	93.6	0.95	70.03	73	WN90T-11G-4
TYCP160L-8-15	15	25.52	1500	94.0	0.95	95.49	73	WN90T-15G-4
TYCP180M-8-15	18.5	31.38	1500	94.3	0.95	117.8	76	WN90T-18.5G-4
TYCP180L-8-15	22	37.15	1500	94.7	0.95	140.1	76	WN90T-22G-4
TYCP200L-8-15	30	50.50	1500	95.0	0.95	191.0	76	WN90T-30G-4
TYCP225S-8-15	37	62.09	1500	95.3	0.95	235.6	78	WN90T-37G-4
TYCP225M-8-15	45	75.28	1500	95.6	0.95	286.5	78	WN90T-45G-4
TYCP250M-8-15	55	91.82	1500	95.8	0.95	350.1	79	WN90T-55G-4
TYCP280S-8-15	75	125.0	1500	96	0.95	477.5	80	WN90T-75G-4
TYCP280M-8-15	90	149.6	1500	96.2	0.95	573.0	80	WN90T-90G-4
TYCP315S-8-15	110	182.5	1500	96.4	0.95	700.3	88	WN90T-110G-4
TYCP315M-8-15	132	218.8	1500	96.5	0.95	840.3	88	WN90T-132G-4
TYCP315L1-8-15	160	265.2	1500	96.5	0.95	1019	88	WN90T-160G-4
TYCP315L-8-15	185	306.6	1500	96.5	0.95	1178	88	WN90T-185G-4

性能数据 Performance Data

380V

型 号 Type	功率 kW	额定 电流 A	额定 转速 r/min	效率 Eff. %	功率 因数 P.F	额定 转矩 N.m	噪声 dB (A)	适配变频器 Inverter
TYCP315L2-8-15	200	331.1	1500	96.6	0.95	1273	88	WN90T-200G-4
TYCP315L3-8-15	220	364.2	1500	96.6	0.95	1400	88	WN90T-220G-4
TYCP315L4-8-15	250	413.5	1500	96.7	0.95	1592	88	WN90T-250G-4
TYCP355M1-8-15	220	364.2	1500	96.6	0.95	1401	95	WN90T-220G-4
TYCP355M-8-15	250	413.5	1500	96.7	0.95	1592	95	WN90T-250G-4
TYCP355L1-8-15	280	463.1	1500	96.7	0.95	1783	95	WN90T-280G-4
TYCP355L-8-15	315	520.4	1500	96.8	0.95	2005	95	WN90T-315G-4
TYCP355L2-8-15	355	586.5	1500	96.8	0.95	2260	102	WN90T-350G-4
TYCP355L3-8-15	375	619.6	1500	96.8	0.95	2387	102	WN90T-400G-4
同步转速 1000 r/min 额定频率 66.67Hz								
TYCP90S-8-10	0.75	1.37	1000	87.4	0.95	7.16	57	WN90T-0.7G-4
TYCP90L-8-10	1.1	1.98	1000	88.7	0.95	10.50	57	WN90T-0.7G-4
TYCP100L-8-10	1.5	2.67	1000	89.9	0.95	14.32	61	WN90T-1.5G-4
TYCP112M-8-10	2.2	3.87	1000	90.9	0.95	21.01	65	WN90T-2.2G-4
TYCP132S-8-10	3	5.23	1000	91.8	0.95	28.65	69	WN90T-3.7G-4
TYCP132M1-8-10	4	6.90	1000	92.7	0.95	38.20	69	WN90T-3.7G-4
TYCP132M2-8-10	5.5	9.42	1000	93.4	0.95	52.52	69	WN90T-5.5G-4
TYCP160M-8-10	7.5	12.76	1000	94.0	0.95	71.62	70	WN90T-7.5G-4
TYCP160L-8-10	11	18.62	1000	94.5	0.95	105.0	70	WN90T-11G-4
TYCP180L-8-10	15	25.17	1000	95.3	0.95	143.2	73	WN90T-15G-4
TYCP200L1-8-10	18.5	31.05	1000	95.3	0.95	176.7	73	WN90T-18.5G-4
TYCP200L2-8-10	22	36.80	1000	95.6	0.95	210.1	73	WN90T-22G-4
TYCP225M-8-10	30	50.08	1000	95.8	0.95	286.5	74	WN90T-30G-4
TYCP250M-8-10	37	61.64	1000	96.0	0.95	353.3	76	WN90T-37G-4
TYCP280S-8-10	45	74.81	1000	96.2	0.95	429.7	78	WN90T-45G-4
TYCP280M-8-10	55	91.34	1000	96.3	0.95	525.2	78	WN90T-55G-4
TYCP315S-8-10	75	124.4	1000	96.4	0.95	716.2	83	WN90T-75G-4
TYCP315M-8-10	90	149.2	1000	96.5	0.95	859.5	83	WN90T-90G-4
TYCP315L1-8-10	110	182.3	1000	96.5	0.95	1050	83	WN90T-110G-4
TYCP315L2-8-10	132	218.8	1000	96.5	0.95	1260	83	WN90T-132G-4
TYCP315L3-8-10	160	265.2	1000	96.5	0.95	1528	83	WN90T-160G-4
TYCP315L4-8-10	185	306.6	1000	96.5	0.95	1767	83	WN90T-185G-4
TYCP355M1-8-10	160	265.2	1000	96.5	0.95	1528	85	WN90T-160G-4
TYCP355M-8-10	185	306.6	1000	96.5	0.95	1767	85	WN90T-185G-4
TYCP355M2-8-10	200	331.5	1000	96.5	0.95	1910	85	WN90T-200G-4
TYCP355L1-8-10	220	364.0	1000	96.5	0.95	2101	85	WN90T-220G-4
TYCP355L-8-10	250	414.3	1000	96.5	0.95	2387	85	WN90T-250G-4
TYCP355L2-8-10	280	464.1	1000	96.5	0.95	2674	91	WN90T-280G-4
TYCP355L3-8-10	315	522.1	1000	96.5	0.95	3008	91	WN90T-315G-4
TYCP355L4-8-10	355	588.4	1000	96.5	0.95	3390	91	WN90T-350G-4
同步转速 750 r/min 额定频率 50Hz								
TYCP90L-8-7.5	0.55	1.11	750	78.9	0.95	7.00	56	WN90T-0.4G-4
TYCP100L-8-7.5	0.75	1.43	750	83.6	0.95	9.55	59	WN90T-0.7G-4
TYCP100L2-8-7.5	1.1	2.06	750	85.2	0.95	14.01	59	WN90T-0.7G-4
TYCP112M-8-7.5	1.5	2.77	750	86.7	0.95	19.10	61	WN90T-1.5G-4

型 号 Type	功率 kW	额定 电流 A	额定 转速 r/min	效率 Eff. %	功率 因数 P.F	额定 转矩 N.m	噪声 dB (A)	适配变频器 Inverter
同步转速 750 r/min 额定频率 50Hz								
TYCP132S-8-7.5	2.2	3.91	750	90.0	0.95	28.01	64	WN90T-2.2G-4
TYCP132M-8-7.5	3	5.27	750	91.0	0.95	38.20	64	WN90T-3.7G-4
TYCP160M1-8-7.5	4	6.97	750	91.8	0.95	50.93	68	WN90T-3.7G-4
TYCP160M2-8-7.5	5.5	9.50	750	92.6	0.95	70.03	68	WN90T-5.5G-4
TYCP160L-8-7.5	7.5	12.87	750	93.2	0.95	95.49	68	WN90T-7.5G-4
TYCP180L-8-7.5	11	18.78	750	93.7	0.95	140.1	70	WN90T-11G-4
TYCP200L-8-7.5	15	25.47	750	94.2	0.95	191.0	73	WN90T-15G-4
TYCP225S-8-7.5	18.5	31.28	750	94.6	0.95	235.5	73	WN90T-18.5G-4
TYCP225M-8-7.5	22	37.08	750	94.9	0.95	280.1	73	WN90T-22G-4
TYCP250M-8-7.5	30	50.45	750	95.1	0.95	382.0	75	WN90T-30G-4
TYCP280S-8-7.5	37	62.09	750	95.3	0.95	471.1	76	WN90T-37G-4
TYCP280M-8-7.5	45	75.36	750	95.5	0.95	573.0	76	WN90T-45G-4
TYCP315S-8-7.5	55	92.01	750	95.6	0.95	700.3	82	WN90T-55G-4
TYCP315M-8-7.5	75	125.3	750	95.7	0.95	954.9	82	WN90T-75G-4
TYCP315L1-8-7.5	90	150.4	750	95.7	0.95	1146	82	WN90T-90G-4
TYCP315L2-8-7.5	110	183.8	750	95.7	0.95	1401	82	WN90T-110G-4
TYCP355M1-8-7.5	132	220.4	750	95.8	0.95	1681	90	WN90T-132G-4
TYCP355M2-8-7.5	160	267.1	750	95.8	0.95	2037	90	WN90T-160G-4
TYCP355L1-8-7.5	185	308.8	750	95.8	0.95	2355	90	WN90T-185G-4
TYCP355L-8-7.5	200	333.9	750	95.8	0.95	2546	90	WN90T-200G-4
TYCP355L2-8-7.5	220	367.3	750	95.8	0.95	2801	90	WN90T-220G-4
TYCP355L3-8-7.5	250	417.4	750	95.8	0.95	3183	90	WN90T-250G-4
同步转速 600 r/min 额定频率 40Hz								
TYCP315S-8-6	45	75.36	600	95.5	0.95	716.2	90	WN90T-45G-4
TYCP315M-8-6	55	92.01	600	95.6	0.95	875.4	90	WN90T-55G-4
TYCP315L1-8-6	75	125.3	600	95.7	0.95	1193.7	90	WN90T-75G-4
TYCP315L2-8-6	90	150.4	600	95.7	0.95	1432.4	90	WN90T-90G-4
TYCP355M1-8-6	110	183.8	600	95.7	0.95	1750.7	90	WN90T-110G-4
TYCP355M2-8-6	132	220.3	600	95.8	0.95	2100.8	90	WN90T-132G-4
TYCP355L1-8-6	160	267.1	600	95.8	0.95	2546.5	90	WN90T-160G-4
TYCP355L-8-6	185	308.8	600	95.8	0.95	2944.4	90	WN90T-185G-4
TYCP355L2-8-6	200	333.8	600	95.8	0.95	3183.1	90	WN90T-200G-4
TYCP355L3-8-6	220	367.2	600	95.8	0.95	3501.4	90	WN90T-220G-4
同步转速 500 r/min 额定频率 33.33Hz								
TYCP355M1-8-5	55	93.08	500	94.5	0.95	1050.4	90	WN90T-55G-4
TYCP355M2-8-5	75	126.6	500	94.7	0.95	1432.4	90	WN90T-75G-4
TYCP355L1-8-5	90	151.9	500	94.7	0.95	1718.9	90	WN90T-90G-4
TYCP355L-8-5	110	185.7	500	94.7	0.95	2100.8	90	WN90T-110G-4
TYCP355L2-8-5	132	222.9	500	94.7	0.95	2521.0	90	WN90T-132G-4

外形及安装尺寸 Dimensions

(单位: mm)

B3 (机座带底脚、端盖无凸缘)

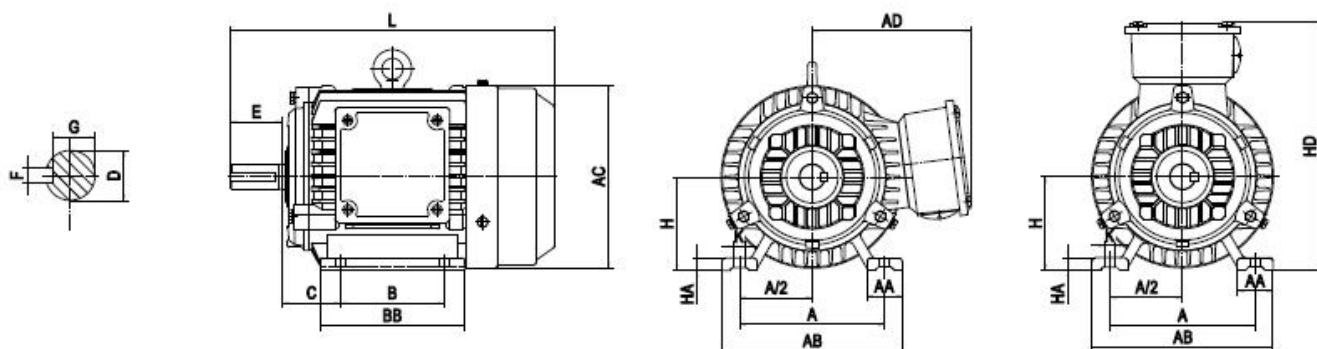

(接线盒位置: 侧式 (默认))

顶式 (可选))

机座号 Frame	转速 Speed	安 装 尺 寸 Mounting Dimension									外 形 尺 寸 Overall Dimension																						
		A	B	C	D	E	F	G	H	K	AA	BB	HA	AB	AC	AD	HD	L															
80M	3000 1500 1000 750	125	100	50	19	40	6	155	80	10	32	135	10	160	165	145	225	295															
90S	3000 1500 1000	140	100	56	24	50	8	20	90	10	34	145	12	180	180	165	255	345															
	750		320																														
90L	3000 1500		125									385																					
	1000 750																	345															
100L	3000 1500 1000 750	160	140	63	28	60	8	24	100	12	39	186	14	200	205	175	275	390															
112M	3000 1000 750	190	140	70	28	60	8	24	112	12	45	200	14	230	225	190	300	425															
	1500																	455															
132S	3000 1500 1000 750	216	140	89	38	80	10	33	132	12	55	190	18	265	270	220	350	475															
132M			178									230						510															
160M		254	210	108	42	110	12	37	160	15	65	260	20	315	320	260	420	610															
160L			254									304						655															
180M		279	241	121	48	110	14	425	180	15	70	311	22	355	360	265	445	680															
180L			279									349						715															
200L		318	305	133	55	110	16	49	200	19	74	379	26	395	400	305	505	770															
225S	1500 750	356	286	149	60	140	18	53	225	19	78	375	28	435	450	325	550	795															
225M	3000		311		55	110	16	49				400						800															
	1500				60	140	18	53										825															
	1000 750																																
250M	3000	406	349	168	65	140	18	58	250	24	80	445	30	490	510	380	630	890															
280S	1500	457	368	190	75	140	20	67.5	280	24	90	485	35	545	550	395	675	970															
280M	1000 750		419		75		20	67.5				536						1025															

外形及安装尺寸 Dimensions

(单位: mm)

机座号 Frame	转速 Speed	安 装 尺 寸 Mounting Dimension									外 形 尺 寸 Overall Dimension											
		A	B	C	D	E	F	G	H	K	AA	BB	HA	AB	AC	AD	HD	L				
315S	3000	508	406	216	65	140	18	58	315	28	120	570	45	635	630	540	855	1180				
315M			457									610						1215				
315L			508									680						1290				
315S	1500		406		80	170	22	71				570						1210				
315M	1000		457									610						1245				
315L	750 600		508									680						1320				
355M	3000	610	560	254	75	140	20	67.5	355	28	130	690	52	735	715	645	1000	1390				
355L/L1			630									80						170	22	71	750	1500
355L2/L3																					690	1530
355M	1500		560		95	170	25	86				690						1420				
355L/L1	1000		630									750						1530				
355L2/L3	750 600											750						1570				

外形及安装尺寸 Dimensions

(单位: mm)

B5 (机座不带底脚、端盖有凸缘)

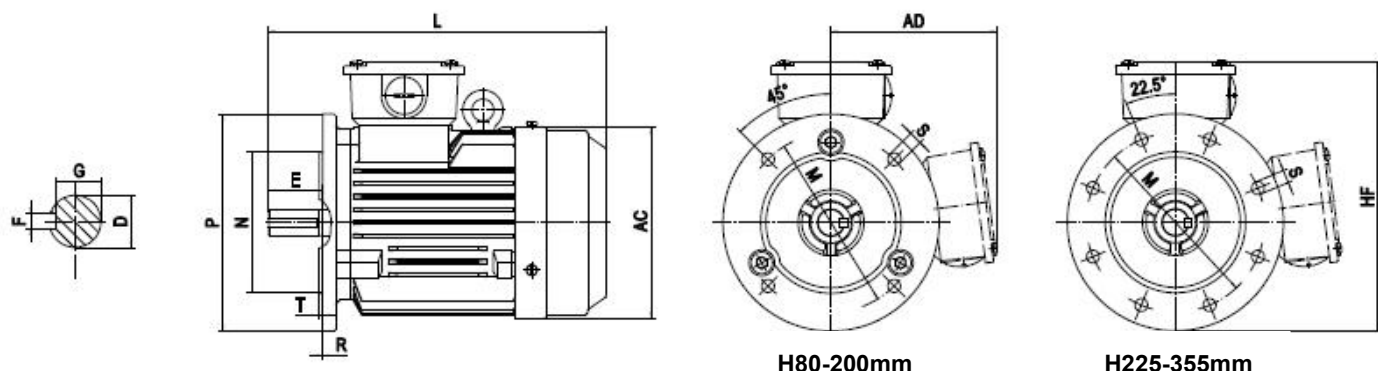

H80-200mm

H225-355mm

机座号 Frame	转速 Speed	安 装 尺 寸 及 公 差 Mounting Dimension										外 形 尺 寸 Overall Dimension														
		D	E	F	G	M	N	P	R	S	T	AC	AD	HF	L											
80M	3000 1500 1000 750	19	40	6	15.5	165	130	200	0	4-Φ12	3.5	165	145	245	295											
90S	3000 1500 1000	24	50	8	20	165	130	200	0	4-Φ12	3.5	180	165	265	345											
	750														320											
90L	3000 1500														385											
	1000 750														345											
100L	3000 1500 1000 750	28	60	8	24	215	180	250	0	4-Φ15	4	205	175	300	390											
112M	3000 1000 750	28	60	8	24	215	180	250	0	4-Φ15	4	225	190	315	425											
	1500														455											
132S	3000 1500 1000 750	38	80	10	33	265	230	300	0	4-Φ15	4	270	220	370	475											
132M															510											
160M		42	110	12	37	300	250	350	0	4-Φ19	5	320	260	435	610											
160L															655											
180M		48		14	42.5	300	250	350	0			360	265	440	680											
180L															715											
200L		55		16	49	350	300	400	0			400	305	505	770											
225S		1500 750	60	140	18	53	400	350	450	0	8-Φ19	5	450	325	550	795										
225M	3000	55	110	16	49	800																				
	1500 1000 750	60	140	18	53	825																				
250M	3000	60	140	18	53	500	450	550	0	8-Φ19	5	510	380	655	890											
	1500 1000 750	65			58																					
280S	3000	65			18											58	500	450	50	0	8-Φ19	5	550	395	670	975
280M																										1025
280S	1500 1000 750	75	20	67.5	1025																					
280M																										

外形及安装尺寸 Dimensions

(单位: mm)

B35 (机座带底脚、端盖有凸缘)

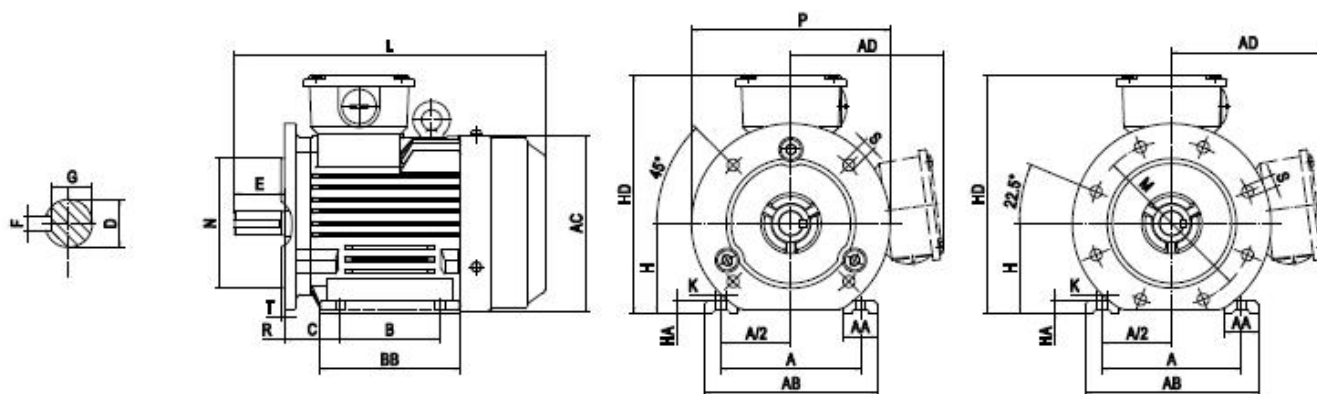

H80-200mm

H225-355mm

[illegible]

外形及安装尺寸 Dimensions

(单位: mm)

机座号 Frame	转速 Speed	安 装 尺 寸 及 公 差 Mounting Dimension																外 形 尺 寸 Overall Dimension							
		A	B	C	D	E	F	G	H	K	M	N	P	R	S	T	AA	BB	HA	AB	AC	AD	HD	L	
280S	3000	457	368	190	65	140	18	58	280	24	500	450	550	0	8-Φ 19	5	90	485	35	545	550	395	675	975	
280M			419		75		20	67.5										536						1025	
280S	1500	508	406	216	65	140	18	58	315	28	600	550	660	0	8-Φ 24	6	120	570	45	635	630	540	855	1180	
280M	1000																	457						610	1215
	750		508															680							
315S	3000	508	406	216	65	140	18	58	315	28	600	550	660	0	8-Φ 24	6	120	570	45	635	630	540	855	1180	
315M			457															610						1215	
315L	1500	508	508	216	80	170	22	71	355	28	740	680	800	0	8-Φ 24	6	130	680	52	735	715	645	1000	1320	
315S			406															570						1210	
315M	1000	610	457	254	95	170	25	86	355	28	740	680	800	0	8-Φ 24	6	130	610	52	735	715	645	1000	1245	
315L	750		508															680						1320	
355M	3000	610	560	254	75	140	20	67.5	355	28	740	680	800	0	8-Φ 24	6	130	690	52	735	715	645	1000	1390	
355L/L1			630															750						1500	
355L2/L3	1500	610	560	254	95	170	25	86	355	28	740	680	800	0	8-Φ 24	6	130	690	52	735	715	645	1000	1420	
355M																		630						750	1530
355L/L1	1000	610	560	254	95	170	25	86	355	28	740	680	800	0	8-Φ 24	6	130	690	52	735	715	645	1000	1530	
355L2/L3	750																	750						1570	
355L2/L3	600				110	210	28	100										750						1570	

接线盒外形及尺寸 Terminal box dimensions

(单位: mm)

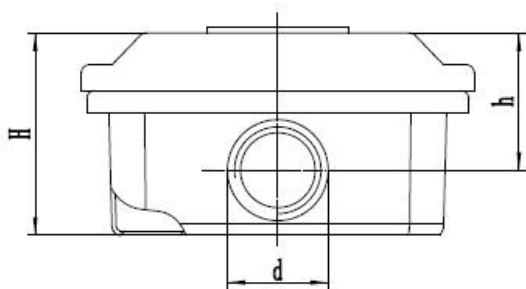

H80-100mm

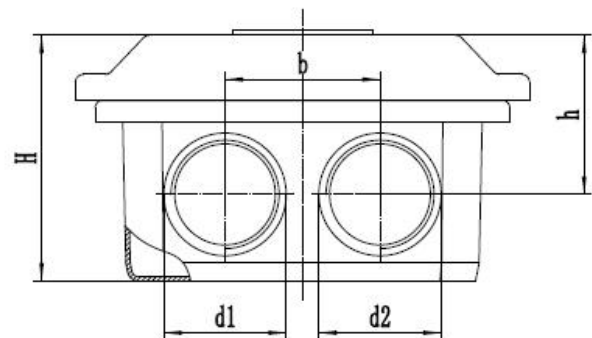

H112-355mm

机座号	H	h	d	d1	d2	b	出线口规格
H80mm	55	37	∅ 28	/	/	/	M24X1.5
H90-100mm	56	38	∅ 28	/	/	/	M24X1.5
H112-132m	68	44	/	∅ 34	∅ 34	43	2-M30X2
H160-180m	83	53	/	∅ 40	∅ 40	60	2-M36X2
H200-225m	105	65	/	∅ 52	∅ 52	78	2-M48X2
H250-280m	121	73.5	/	∅ 69	∅ 69	90	2-M64X2
H315mm	170	105	/	∅ 72	∅ 72	120	2-M64X2
H355m	180	110	/	∅ 80	∅ 80	130	2-M72X2

常用的安装结构型式，以及适用的机座号见下表

Conventional mounting type and suitable frame size are given in following table (with “√”)

机座号 Frame	基本安装结构			派生的安装形式													
	Basic Type			Derived Type													
	B3	B5	B35	V1	V3	V5	V6	B6	B7	B8	V15	V17	V35	V37	B14	B34	V18
80~112	√	√	√	√	√	√	√	√	√	√	√	√	√	√	√	√	√
132~160	√	√	√	√	√	√	√	√	√	√	√	√	√	√	-	-	-
180~280	√	√	√	√	-	-	-	-	-	-	-	-	-	-	-	-	-
315~355	√	-	√	√	-	-	-	-	-	-	-	-	-	-	-	-	-

注：“√”表示可以制造生产的结构型式。电机订购时若不作说明，默认接线盒为侧式右出线。
以上数据,如有变更,恕不另行通知。Without request specified in order or agreement terminal box position is standard at the right side of frame seen from DE view.Data above may be changed without prior notice.

WN90T 永磁同步电机专用变频器

WN90T Inverter special for Permanent Magnet Synchronous Motor

产品概述 Product profile



WN90T 同步变频器是针对三相交流永磁同步电机闭环、开环矢量控制的专用变频器，以下为其使用参数说明。

WN90T SVC or FVC inverter is specially designed for permanent magnet synchronous motor, and its performance data see below chart.

性能数据 Performance Data

项目名称	规格
------	----

基本控制功能	控制方式	开环矢量控制（SVC）、闭环矢量控制（FVC）				
	输出频率	0~600Hz				
	载波频率	0.5kHz~16kHz（可根据负载特性，自动调整载波频率）				
	输入频率分辨率	数字设定：0.01Hz 模拟设定：最高频率 × 0.025%				
	启动转矩	0.5Hz/150%（SVC）、0Hz/180%（FVC）				
	调速范围	1:200（SVC）、1:1000（FVC）				
	稳速精度	±0.5%（SVC）、±0.02%（FVC）				
	过载能力	150%额定电流 60s; 180%额定电流 3s				
变频器型号	输入电压	额定输出功率（kW）	额定输入电流（A）	额定输出电流（A）	适配电机（KW）	备注
WN90T-0.4G-2	1PH AC220V ±15%	0.4	5.4	2.5	0.4	-
WN90T-0.75G-2		0.75	7.2	5	0.75	
WN90T-1.5G-2		1.5	10	7.0	1.5	
WN90T-2.2G-2		2.2	16	11.0	2.2	
WN90T-3.7G-2		3.7	17	16.5	3.7	
WN90T-5.5G-2		5.5	26	25	5.5	
WN90T-7.5G-2		7.5	35	32	7.5	
WN90T-0.4G-4	3PH AC380V ±15%	0.4	3.4	1.2	0.4	
WN90T-0.75G-4		0.75	3.8	2.5	0.75	
WN90T-1.5G-4		1.5	5	3.7	1.5	
WN90T-2.2G-4		2.2	5.8	5.0	2.2	
WN90T-3.7G/5.5P-4		3.7/5.5	10/15	9/13	3.7/5.5	
WN90T-5.5G-4		5.5	15	13	5.5	

性能数据 Performance Data

变频器型号	输入电压	额定输出功率（kW）	额定输入电流（A）	额定输出电流（A）	适配电机（KW）	备注
WN90T-7.5P-4	3PH AC380V ±15%	7.5	20	17	7.5	- 可选配 直流电抗器
WN90T-7.5G/11P-4		7.5/11	20/26	17/25	7.5/11	
WN90T-11G/15P-4		11/15	26/35	25/32	11/15	
WN90T-15G/18.5P-4		15/18.5	35/38	32/37	15/18.5	
WN90T-18.5G/22P-4		18.5/22	38/46	37/45	18.5/22	
WN90T-22G/30P-4		22/30	46/62	45/60	22/30	
WN90T-30G/37P-4		30/37	62/76	60/75	30/37	
WN90T-37G/45P-4		37/45	76/90	75/90	37/45	
WN90T-45G/55P-4		45/55	92/113	90/110	45/55	
WN90T-55G-4		55	113	110	55	
WN90T-75P-4		75	157	150	75	
WN90T-75G/90P-4		75/90	157/180	150/176	75/90	
WN90T-90G/110P-4		90/110	180/214	176/210	90/110	
WN90T-110G/132P-4		110/132	214/256	210/253	110/132	
WN90T-132G/160P-4		132/160	256/307	253/300	132/160	
WN90T-160G/185P-4		160/185	307/355	300/340	160/185	
WN90T-185G/200P-4		185/200	355/385	340/380	185/200	
WN90T-200G/220P-4		200/220	385/430	380/420	200/220	

WN90T-220G/250P-4		220/250	430/475	420/470	220/250	
WN90T-250G/280P-4		250/280	475/525	470/520	250/280	
WN90T-280G/315P-4		280/315	525/610	520/600	280/315	
WN90T-315G/350P-4		315/350	610/665	600/640	315/350	
WN90T-350G/400P-4		350/400	665/700	640/690	350/400	
WN90T-400G/450P-4		400/450	700/800	690/790	400/450	
WN90T-450G/500P-4		450/500	800/865	790/860	450/500	
WN90T-500G/560P-4		500/560	865/960	860/950	500/630	
WN90T-560G/630P-4		560/630	960/1112	950/1100	560/630	
WN90T-630G/710P-4		630/710	1112/1290	1100/1280	630/710	
WN90T-710G/800P-4		710/800	1290/1472	1280/1380	710/800	
WN90T-800G/900P-4		800/900	1472/1680	1380/1640	800/900	
WN90T-900G/1000P-4		900/1000	1680/1800	1640/1720	900/1000	
WN90T-1000G-4		1000	1800	1720	1000	

标配
直流电抗器

标配交流
输入电抗器

外形及安装尺寸 Dimension

(单位: mm)

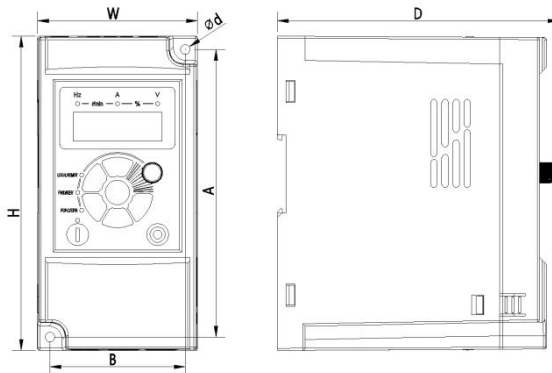
型号	W	H	D	A	B	Ød	外形
WN90T-0.4G-2 WN90T-0.75G-2 WN90T-1.5G-2 WN90T-0.4G-4 WN90T-0.75G-4 WN90T-1.5G-4 WN90T-2.2G-4	72	142	127	130	61	4.5	
WN90T-2.2G-2 WN90T-3.7G-2 WN90T-3.7G/5.5P-4 WN90T-5.5G-4 WN90T-7.5P-4	85	180	131	167	72	5.5	

外形及安装尺寸 Dimension

(单位: mm)

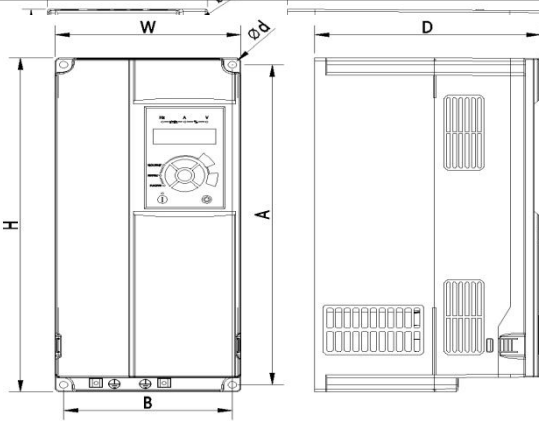
型号 Model	W	H	D	A	B	Ød	外形 Outline
WN90T-5.5G-2 WN90T-7.5G/11P-4 WN90T-11G/15P-4	106	240	168	230	96	4.5	
WN90T-7.5G-2 WN90T-15G/18.5P-4 WN90T-18.5G/22P-4 WN90T-22G/30G-4	151	332	183	318	137	7	
WN90T-30G/37P-4 WN90T-37G/45P-4	217	400	216	385	202	7	

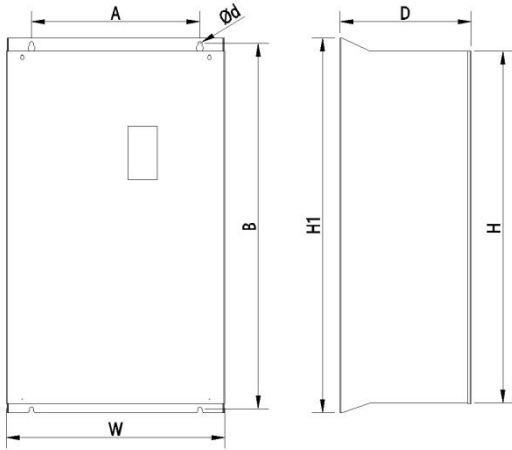
型号 Model	W	H	H1	D	A	B	Ød	外形 Outline
WN90T-45G/55P-4 WN90T-55G-4 WN90T-75P-4	300	440	470	240	200	455	9	
WN90T-75G/90P-4 WN90T-90G/110P-4 WN90T-110G/132P-4	275	590	630	311.5	200	612	9	
WN90T-132G/160P-4 WN90T-160G/185P-4	400	675	715	311.5	320	695	11	
WN90T-45G/55P-4L WN90T-55G-4L WN90T-75P-4L	300	500	540	254	200	522	9	
WN90T-75G/90P-4L	338	546	576	258	270	560	9	
WN90T-90G/110P-4L WN90T-110G/132P-4L	338	550	580	301.5	270	564	9	
WN90T-132G/160P-4L WN90T-160G/185P-4L	400	871.5	915	310	320	895	11	
WN90T-185G/200P-4 WN90T-200G/220P-4 WN90T-220G/250P-4	400	790	830	320	160+ 160	810	11	
WN90T-250G/280P-4 WN90T-280G/315P-4 WN90T-315G/350P-4	530	920	970	350	215+ 215	950	11	

外形及安装尺寸 Dimension

(单位: mm)

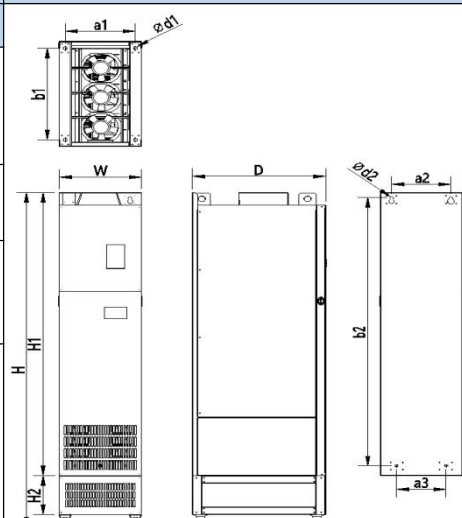
型号 Model	外形尺寸 Outline dimension (mm)					卧式 Floor-mounte d Size (mm)			挂壁式 Wall-mounted Size (mm)				外形 Outline
	W	H	H1	H2	D	a1	b1	d1	a2	a3	b2	d2	
WN90T-185G/200P-4L WN90T-200G/220P-4L WN90T-220G/250P-4L	300	1445	1180	200	500	250	430	14	220	150	1135	13	
WN90T-250G/280P-4L	330	1595	1330	200	545	280	475	14	220	185	1275	13	
WN90T-280G/315P-4L WN90T-315G/350P-4L	325	1720	1455	200	545	275	470	14	225	185	1175	14	
WN90T-350G/400P-4 WN90T-400G/450P-4 WN90T-450G/500P-4	335	1720	1455	200	545	285	470	14	240	200	1380	14	

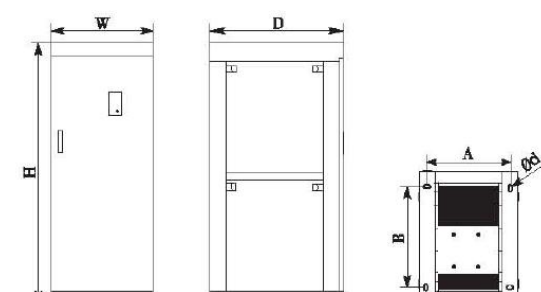
型号 Model	W	H	D	A	B	Ød	外形 Outline
WN90T-500G/560P-4 WN90T-560G/630P-4 WN90T-630G/710P-4	650	1600	800	600	700	13	
WN90T-710G/800P-4 WN90T-800G/900P-4 WN90T-900G/1000P-4 WN90T-1000G-4	700	2200	1000	650	900	13	

基本配线图:

1) 1PH/220V 0.4-2.2kW&3PH/380V 0.4-2.2kW (VF 控制)

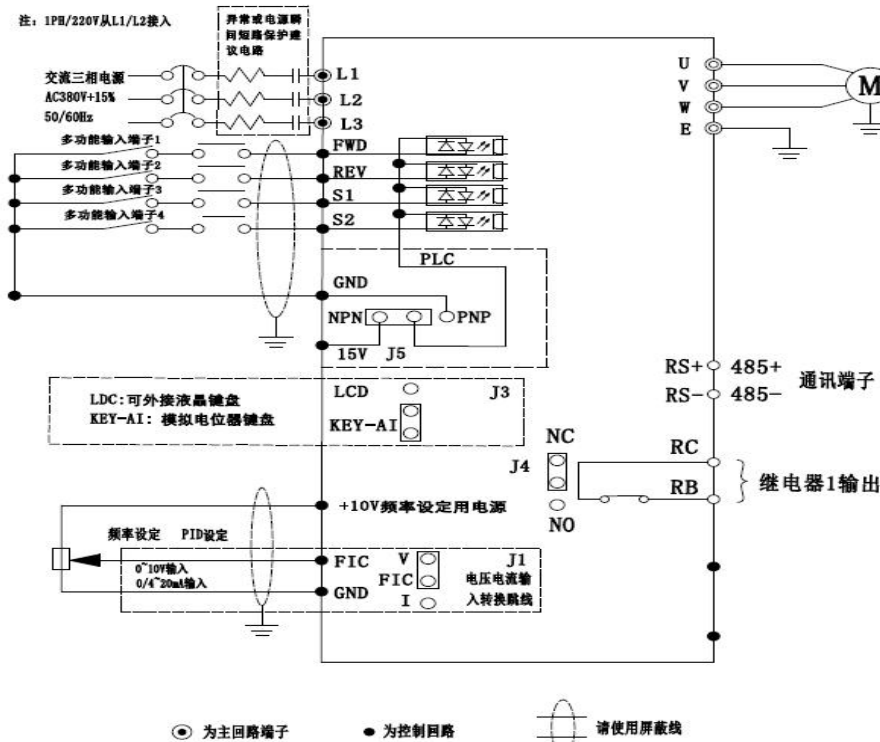

2) 1PH/220V 0.4-3.7kW&3PH/380V 0.4-5.5kW (矢量控制)

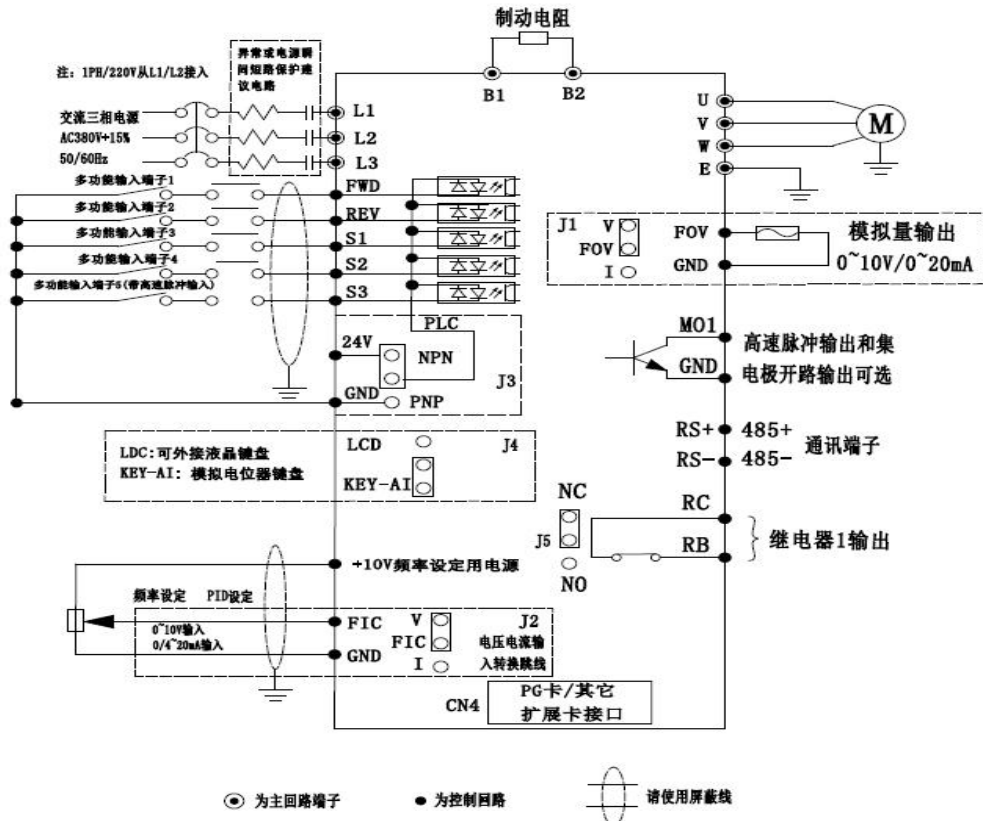

3) 220V/5.5-7.5kW&380V/7.5kW-160kW

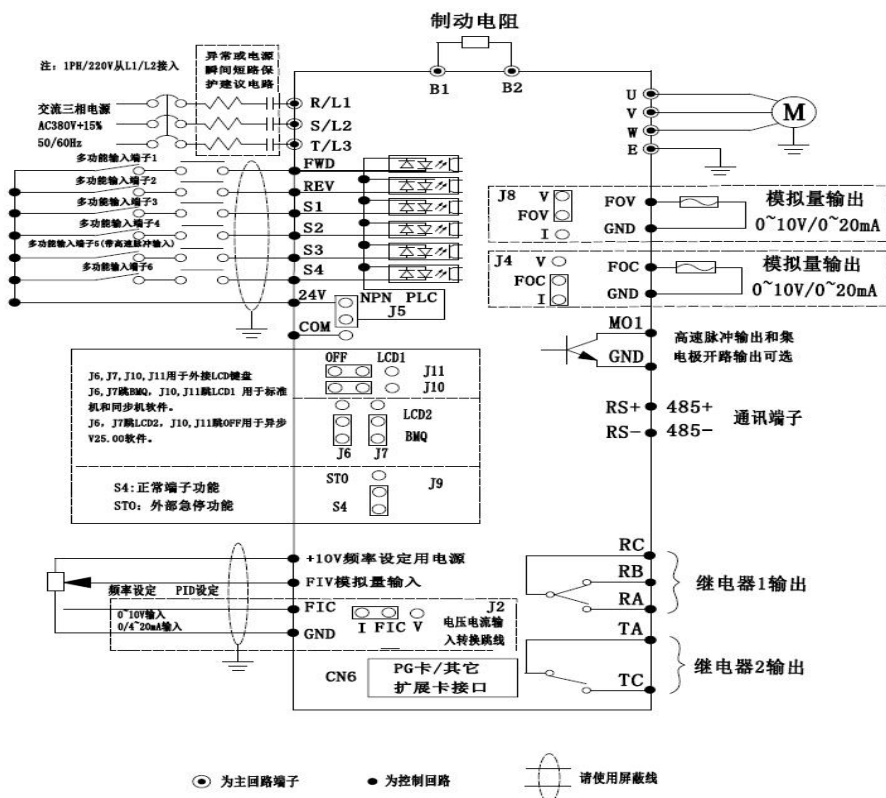

备注 1:

220V/5.5-7.5kW&380V/7.5-37kW 标准内置制动单元, 45kW-160kW 制动单元选配。

备注 2: 30-160kW 内置直流电抗器 可选配。

4) 380V/185kW-450kW

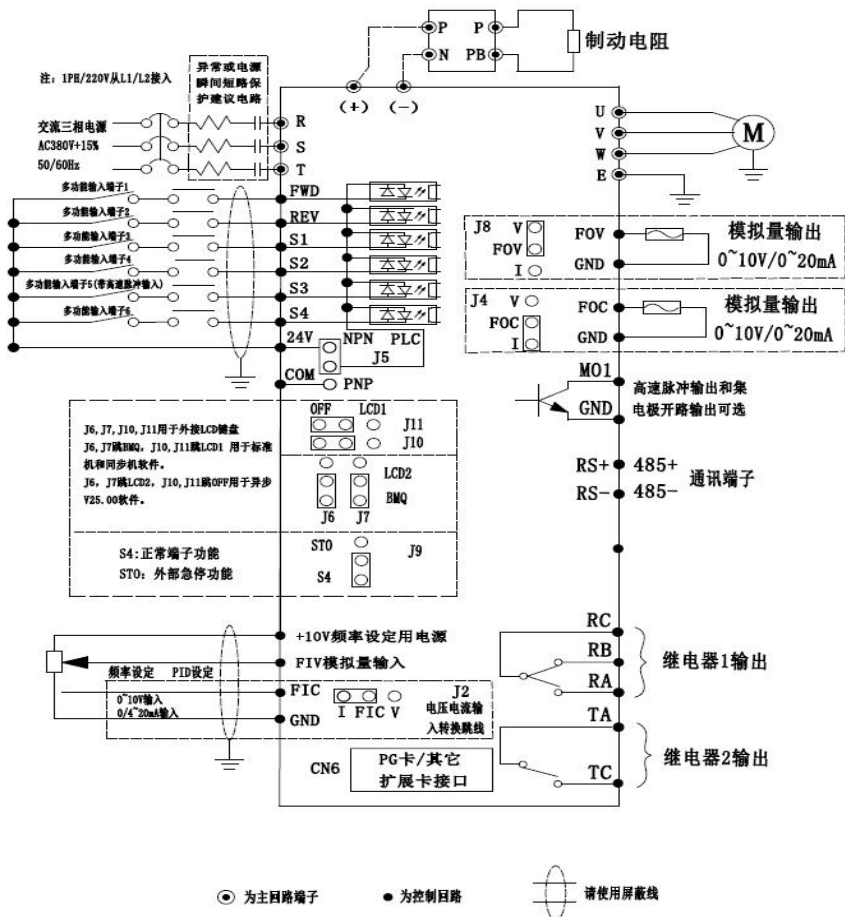

备注 1: 185-315kW 内置制动单元 可选配;

备注 2: 185-315kW 内置直流电抗器 可选配; 350-450kW 标配直流电抗器。

5) 380V/500-1000kW

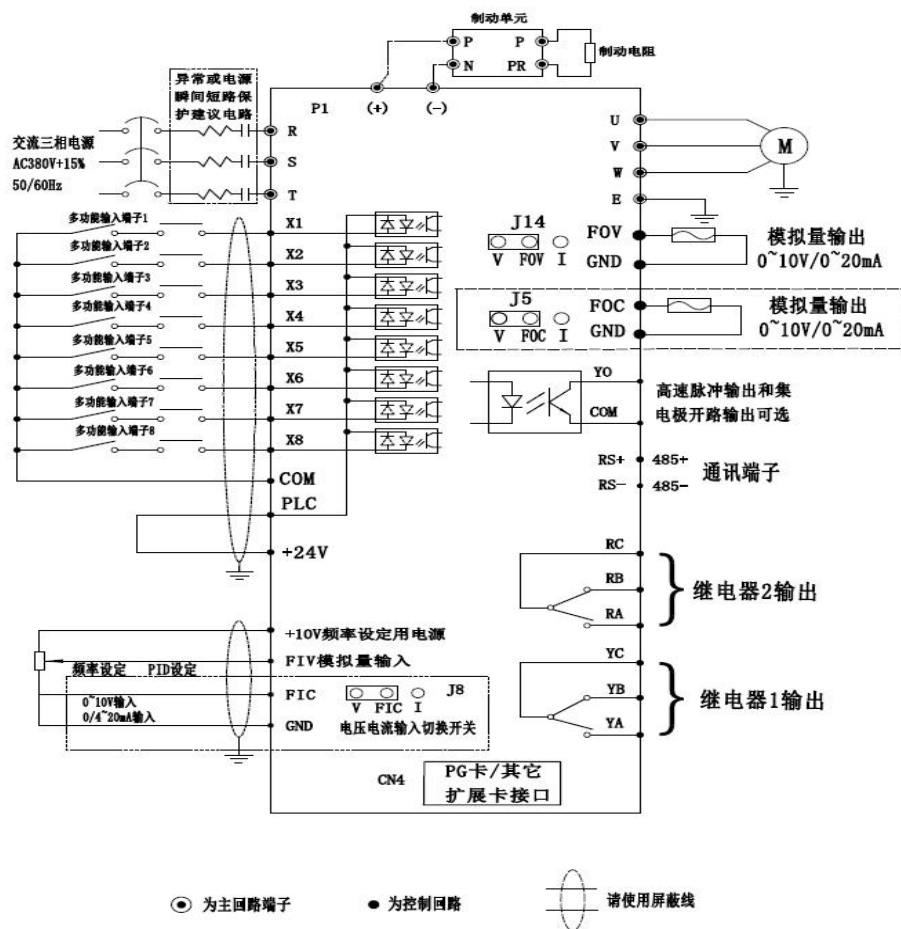

备注 1: 500-630kW 标配直流电抗器, 710-1000kW 标配交流输入电抗器。